

ULTRATREX AT400 / AT400PS



CER NO. - TUV 400-01-2043
ISO 9001 : 2015

INTRODUCTION

The Ultratrex Amphibious Excavator is designed to travel and operate safely and efficiently on soft terrain such as swamps, wetlands, and shallow waters. Its well-engineered amphibious hydraulic undercarriage provides ultra-low ground pressure and exceptional mobility, making it ideal for soft terrain and swamp applications. We manufacture amphibious hydraulic undercarriages for excavators ranging from 15 to 50 tons.

FEATURES

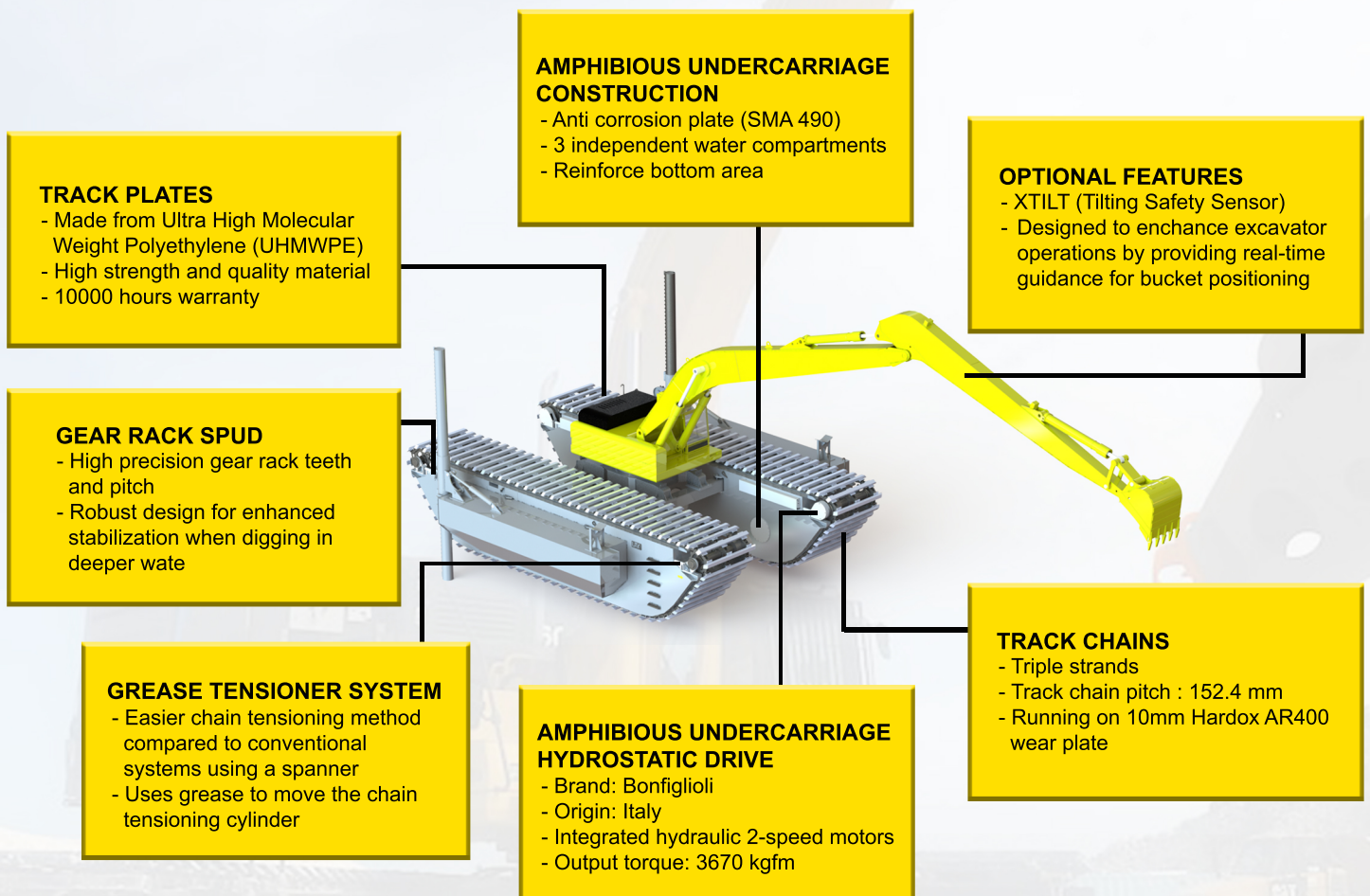

APPLICATIONS

- Swamp land clearing for mining, plantations and forest areas
- Deepening of canals, river channels and river mouths
- Building bunds for flood prevention and land reclamation
- Sludge removal from lakes, ponds and water reservoirs
- Digging trenches for oil and gas pipeline installations
- Transporting and clearing landslides and flood hit areas
- Swamp and wetland construction
- Road construction through wetlands

AT400 TECHNICAL SPECIFICATIONS

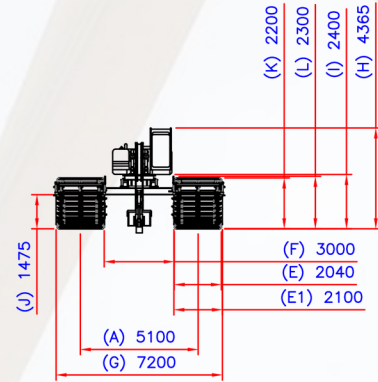
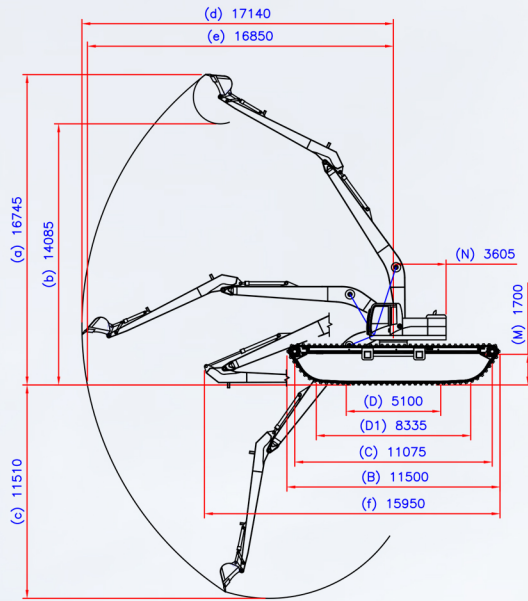

GENERAL SPECIFICATIONS		
Base Machine	40 - 45 Ton Excavator	
Total Weight	Without Side Pontoon	58000 kg
Floating Capacity		72 m3
Floating Capacity/Total Weight		1.24 m3/ton
Maximum Torque Motor		3670 kgf-m
Ground Pressure		0.15 kg/cm2
Travel Speed	High	3.2 km/h
	Low	1.8 km/h
Maximum Gradient	30 °	

WORK EQUIPMENT	
Boom Length	9727 mm
Arm Length	6650 mm
Bucket Capacity	1.1 m3

WORKING RANGES	
a. Maximum Digging Height	16745 mm
b. Maximum Dumping Height	14085 mm
c. Maximum Digging Depth	1510 mm
d. Maximum Digging Reach	17140 mm
e. Maximum Digging Reach On Ground	16850 mm
f. Total Length During Parking	15950 mm

*Dimensions are based on a 17m Long Reach Arm and 1.1m3 General Purpose Bucket

DIMENSIONS	
A. Track Gauge	5100 mm
B. Track Length	11500 mm
C. Distance Between Idler And Sprocket	10075 mm
D. Track Length On Hard Ground	5100 mm
D1. Track Length On Soft Ground	8335 mm
E. Width Track Shoe	2040 mm
E1. Width Float	2100 mm
F. Distance Between Shoe Inside	3000 mm
G. Overall Machine Width	7200 mm
H. Overall Machine Height	4365 mm
I. Ground Clearance (Counterweight)	2400 mm
J. Minimum Ground Clearance	1475 mm
K. Shoe Setting Height	2200 mm
L. Crawler Height	2300 mm
M. Water Line Height	1700 mm
N. Minimum Swing Radius	3605 mm

AT400PS TECHNICAL SPECIFICATIONS

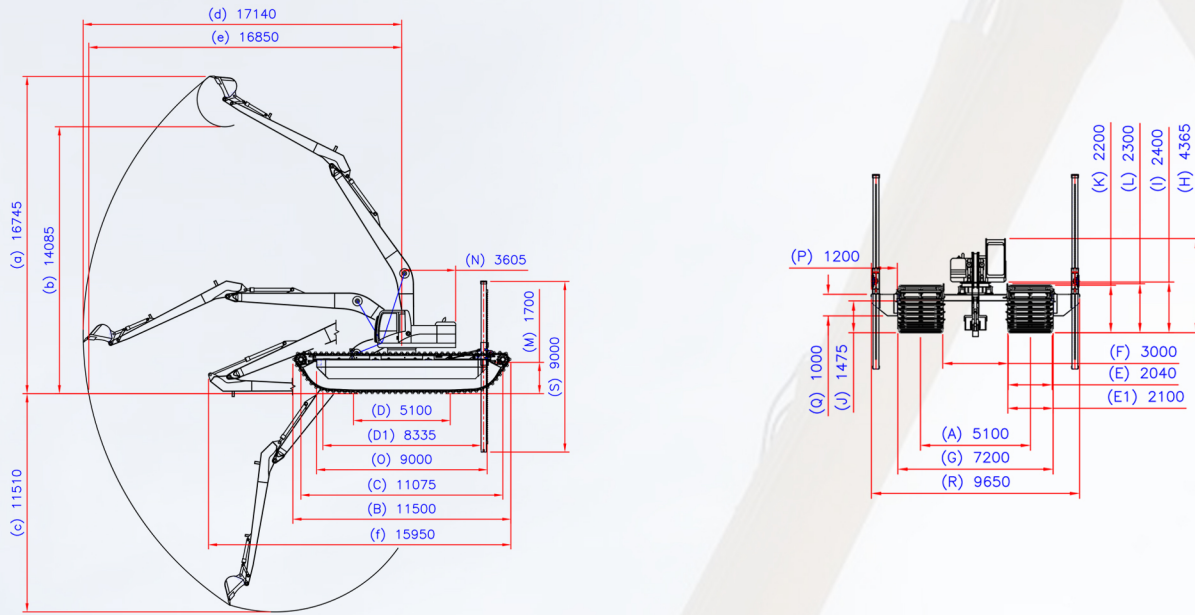

GENERAL SPECIFICATIONS		
Base Machine	40 - 45 Ton Excavator	
Total Weight	Without Side Pontoon	58000 kg
Floating Capacity		72 m ³
Floating Capacity/Total Weight		1.24 m ³ /ton
Maximum Torque Motor		3670 kgf-m
Ground Pressure		0.15 kg/cm ²
Travel Speed	High	3.2 km/h
	Low	1.8 km/h
Maximum Gradient	30 °	

WORK EQUIPMENT	
Boom Length	9727 mm
Arm Length	6650 mm
Bucket Capacity	1.1 m ³

WORKING RANGES	
a. Maximum Digging Height	16745 mm
b. Maximum Dumping Height	14085 mm
c. Maximum Digging Depth	11510 mm
d. Maximum Digging Reach	17140 mm
e. Maximum Digging Reach On Ground	16850 mm
f. Total Length During Parking	15950 mm

*Dimensions are based on a 17m Long Reach Arm and 1.1m³ General Purpose Bucket

DIMENSIONS	
A. Track Gauge	5100 mm
B. Track Length	11500 mm
C. Distance Between Idler And Sprocket	10075 mm
D. Track Length On Hard Ground	5100 mm
D1. Track Length On Soft Ground	8335 mm
E. Width Track Shoe	2040 mm
E1. Width Float	2100 mm
F. Distance Between Shoe Inside	3000 mm
G. Overall Machine Width	7200 mm
H. Overall Machine Height	4365 mm
I. Ground Clearance (Counterweight)	2400 mm
J. Minimum Ground Clearance	1475 mm
K. Shoe Setting Height	2200 mm
L. Crawler Height	2300 mm
M. Water Line Height	1700 mm
N. Minimum Swing Radius	3605 mm

ADDITIONAL DIMENSIONS (SIDE PONTOON)	
O. Side Pontoon Length	9000 mm
P. Side Pontoon Width	1200 mm
Q. Side Pontoon Height	1000 mm
R. Overall Machine Width	9650 mm
S. Spud Length	9000 mm

ULTRATREX AT400/AT400PS



GALLERY



**UTX, YOUR TRUSTED PARTNER
IN DREDGING & ENVIRONMENTAL CONTROL SOLUTIONS**



CER NO : TUV 100-01-2043
ISO 9001 : 2015



For more information on Ultratrex products, dredging,
and environmental control solutions, visit our website at
www.amphibiousexcavator.com

Materials and specifications are subject to change without notice.
The brochure may feature additional equipment.
Contact your Ultratrex dealer for available options.



ULTRATREX MACHINERY SDN. BHD.

PL0 229, Jalan Kencana Mas 2, Kawasan Perindustrian Tebrau 3,
81100 Johor Bahru, Johor, Malaysia

Tel : +607-355 7777

Fax : +607-351 0229

Email : marketing@ultratrex.com.my